

Claycutter X

Deep Water Excavation System

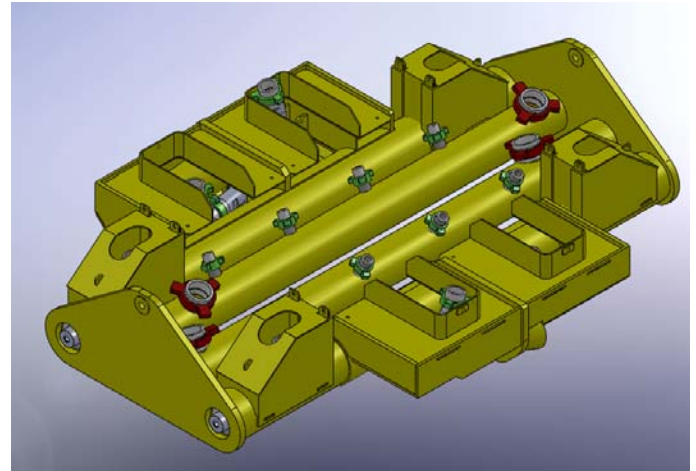

<ul style="list-style-type: none"> • Latest in Deep Water Subsea Excavation technology 	<ul style="list-style-type: none"> • Capable of ultra-deep water operation, up to 3000m WD
<ul style="list-style-type: none"> • High pressure jetting system, capable of cutting soils up to 500kPa shear strength 	<ul style="list-style-type: none"> • High Volume capability for conversion to Mass Flow Excavation
<ul style="list-style-type: none"> • Proven track record in the field 	

APPLICATIONS

<ul style="list-style-type: none"> • Pipeline Route Preparation 	<ul style="list-style-type: none"> • Seabed preparation for Templates, Manifolds etc
<ul style="list-style-type: none"> • Silo Construction - Mud Line Cellars & Glory Holes 	<ul style="list-style-type: none"> • Trench Construction in soft to very stiff clay, sand, gravel and carbonate soils

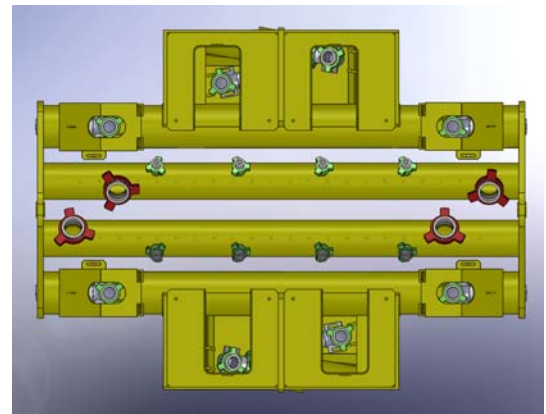
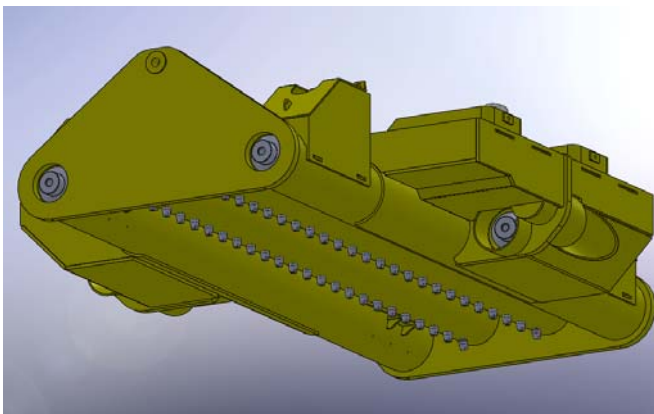

WEIGHTS & DIMENSIONS	
Total Weight	7 500 Kg
Width	4 100mm
Height	920mm
EXCAVATION RATES*	
Sand	500 m ³ /Hr
Silt	500 m ³ /Hr
Gravel	500 m ³ /Hr
Rock Dump	500 m ³ /Hr
Clay (<10 kPa)	500 m ³ /Hr
10kPa <Clay< 100kPa	100 - 300 m ³ /Hr
100kPa < Clay <500kPa	5 - 50 m ³ /Hr
PERFORMANCE	
Jetting Nozzle Exit Water Velocity (24 Nozzles)	58.0 m/sec
Working Pressure	200 bar
Operational Water Depth	Unlimited
Max Tidal Current	Unlimited

*Excavation rates quoted are indicative only and are not guaranteed.

TYPICAL EXCAVATION SITE

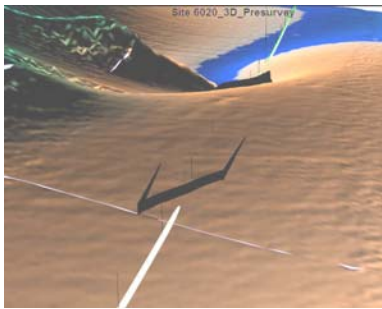
	Before	After	
			
<p>Site Statistics:</p> <ul style="list-style-type: none"> • Excavated Volume - 279m³ (37m x 3.5m x 2.2m) • Soft Clay (5-15 kPa) with some Stiff Clay (100-250kPa) • 2 pumps @ 165 Bar/1800rpm • Only 1 Jet Manifold (24 Jets) used • Excavation Time – 4 hrs 30 mins 			